

HOLLOW CORE PLANK CONNECTION

GENERAL INSTRUCTIONS FOR DRILLING HOLES IN HOLLOW-CORE PLANKS

1. HOLES SHOULD BE DRILLED IN CORES WHEREVER POSSIBLE.
(NOTE CUT SIDES OF PLANKS ARE MOST VISIBLE FROM THE UNDERSIDE)

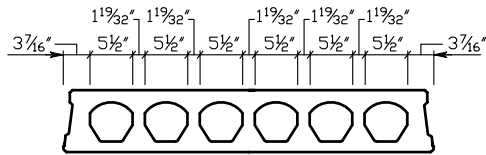

FULL WIDTH PLANKS

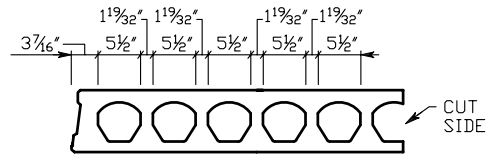

CUT PLANKS BETWEEN
3'-3 3/8" & 3'-7 3/4" WIDE

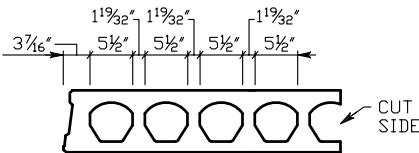

CUT PLANKS BETWEEN
2'-8 3/8" & 3'-0 5/8" WIDE

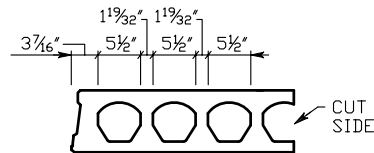

CUT PLANKS BETWEEN
2'-1 1/4" & 2'-5 5/8" WIDE

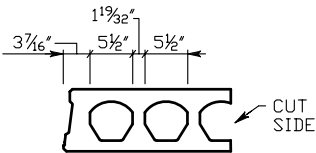

CUT PLANKS BETWEEN
1'-6 1/8" & 1'-10 1/2" WIDE



CUT PLANKS BETWEEN
1'-1 1/4" & 1'-3 3/8" WIDE

2. DO NOT CONCENTRATE HOLES
AT ONE PLACE IN PLANK

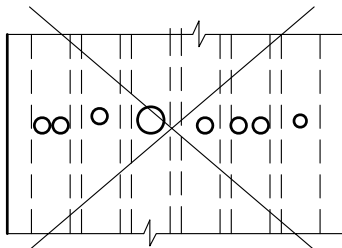

NO

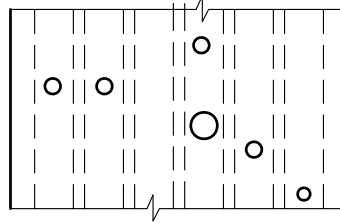

OK

3. OBVIOUSLY SOME CASES MIGHT INVOLVE CUTTING A WEB. IN GENERAL THIS MAY BE DONE IN PLANKS THAT MEET ALL OF THE FOLLOWING:

- a.) ONLY IN 4'-0" WIDE PLANKS
- b.) ONLY CUT INTO TWO WEBS PER PLANK
- c.) PLANKS WITH NO FACTORY CUT OPENINGS
- d.) PLANKS NOT SUPPORTING OTHER PLANKS
- e.) NO CLOSER THAN EVERY FOURTH PLANK

4. FOR SPECIFIC LOCATION QUESTIONS, EITHER MORE CRITICAL THAN ABOVE OR NOT MENTIONED ABOVE, PLEASE CONTACT THE ENGINEERING DEPARTMENT AT N.C.P. @ (717-267-4505) OR FAX (717-267-4518) A DETAIL OF THE LOCATION FOR OUR APPROVAL

2655 MOLLY PITCHER HIGHWAY SOUTH
BOX N, CHAMBERSBURG, PA 17201-0813
(717) 267-4505 FAX (717) 267-4518
ESTABLISHED 1923

NITTEHOUSE
CONCRETE PRODUCTS

