

Prestressed Concrete 32"x12' Double Tee (NO TOPPING)

PHYSICAL PROPERTIES	
Precast	
A = 663 in. ²	S _b = 2800 in. ³
I = 63,361 in. ⁴	S _t = 6762 in. ³
Y _b = 22.63 in.	Wt. = 691 PLF
Y _t = 9.37 in.	Wt. = 58 PSF

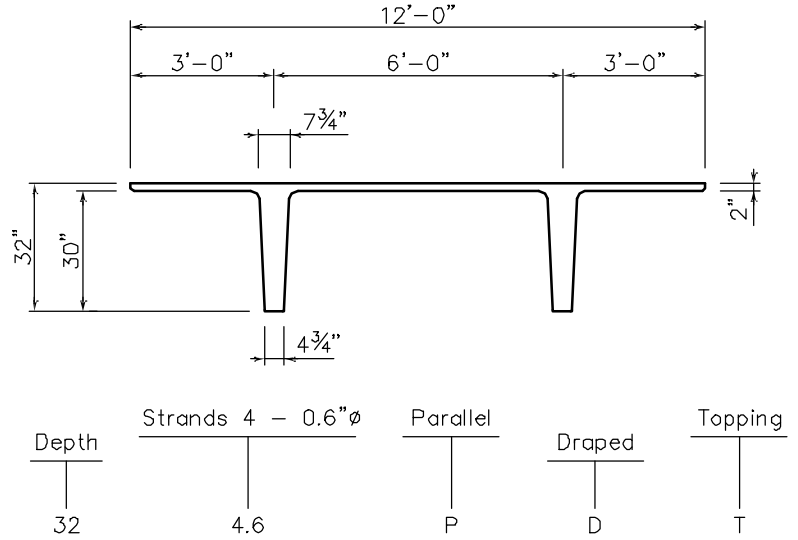

DESIGN DATA

1. Precast strength @ RELEASE = 3000 PSI. (min.)
2. Precast strength @ 28 days = 6000 PSI.
3. Precast Density = 150 PCF
4. Strand = 0.6" ϕ 270k LO-relaxation.
5. Maximum bottom tensile stress is $12\sqrt{f'_c} = 930$ PSI.
6. All superimposed load is treated as live load in the flexural strength analysis.
7. Flexural capacity is based on stress/strain strand relationships.
8. Maximum moment capacity is critical at midspan for parallel strands and is critical near 0.4 span for draped strands.

Table of Safe Superimposed Loads (lbs. per sq. ft.)																						
Section	ϕM_n (in. Kips)	Span in Feet																				
		52	54	56	58	60	62	64	66	68	70	72	74	76	78	80	82	84	86	88	90	92
32-4.6 P	6,075	26																				
32-6.6 P	8,806	59	51	44	38	32																
32-8.6 P	11,280	88	79	70	62	55	48	42	37	32												
32-10.6 P	13,476	115	104	93	83	75	67	60	54	48	42	38	33									
32-12.6 P	15,554	140	126	114	103	93	84	76	69	62	56	50	45	40	36	32						
32-14.6 D	20,052	194	176	161	146	134	122	112	102	94	86	78	72	66	59	54	50	45	41	37	33	30
32-16.6 D	22,484				171	156	143	132	121	111	102	93	85	78	71	65	59	53	48	44	40	37
32-18.6 D	24,653										117	107	98	90	83	76	69	63	58	53	48	43

This table is for simple spans and uniform loads. Design data for any of these span-load conditions is available on request. Individual designs may be furnished to satisfy unusual conditions of heavy loads, concentrated loads, cantilevers, flange or stem openings and narrow widths.



2655 MOLLY PITCHER HWY. SOUTH, BOX N
CHAMBERSBURG, PA 17201-0813
717-267-4505 • FAX: 717-267-4518